



Pocket WiFi + LAN

Installation Manual





www.solaxpower.com

Safety

General Notice

1. Contents may be periodically updated or revised. SolaX reserves the right to make improvements or changes in the product(s) and the program(s) described in this manual without the prior notice.
2. The installation and maintenance can only be performed by qualified personnel who:
 - Are licensed and/or satisfy state and local jurisdiction regulations;
 - Have good knowledge of this manual and other related documents.
3. Before installing the device, carefully read, fully understand and strictly follow the detailed instruction of this manual and other related regulations. SolaX shall not be liable for any consequences caused by the violation of the storage, transportation, installation, and operation regulations specified in this document and the user manual.
4. Use insulated tools when installing the device. Individual protective tools must be worn during installation, electrical connection and maintenance.
5. Please visit the website www.solaxpower.com of SolaX for more information.

Descriptions of Labels

	CE mark of conformity		UKCA mark of conformity
	RCM mark of conformity		FCC mark of conformity
	Do not dispose of the device together with household waste.		

⚠ RF EXPOSURE WARNING!

- Install and operate the device in accordance with provided instructions.
- This equipment complies with FCC radiation exposure limits set forth for an uncontrolled environment. This equipment should be installed and operated with minimum distance 20cm between the radiator & your body.
- End-users and installers must be provided with antenna installation instructions and transmitter operating conditions for satisfying RF exposure compliance.

⚠ CAUTION!

- Do not dismantle or scrap by force.
- Anti-static measures should be taken to decrease the damage of static electricity to electronic components.
- Keep away from flammable, explosive materials.
- All the product labels and nameplate on the module shall be maintained clearly visible.

CE DECLARATION OF COMFORMITY

- The product conforms to RF specifications and technical standards.
- The device complies with DOC declaration.
- The device meets the basic requirements and other relevant provisions of 2014/53/EU directive.
- The device is allowed to be used in all EU member states.

This device complies with part 15 of the FCC Rules Operation is subject to the following two conditions:

- (1) This device may not cause harmful interference, and
- (2) This device must accept any interference received, including interference that may cause undesired operation.

Any changes or modifications not expressly approved by the party responsible for compliance could void the user's authority to operate the equipment.

Note: This equipment has been tested and found to comply with the limits for a Class B digital device, pursuant to part 15 of the FCC Rules. These limits are designed to provide reasonable protection against harmful interference in a residential installation. This equipment generates, uses and can radiate radio frequency energy and, if not installed and used in accordance with the instructions, may cause harmful interference to radio communications. However, there is no guarantee that interference will not occur in a particular installation. If this equipment does cause harmful interference to radio or television reception, which can be determined by turning the equipment off and on, the user is encouraged to try to correct the interference by one or more of the following measures:

- Reorient or relocate the receiving antenna.
- Increase the separation between the equipment and receiver.
- Connect the equipment into an outlet on a circuit different from that to which the receiver is connected.
- Consult the dealer or an experienced radio/TV technician for help.

Installation requirements

For Wi-Fi mode, the longest connection distance between the router and the equipment should be no more than 100 meters; if there is a wall between the router and the equipment, the longest connection distance is 20 meters.

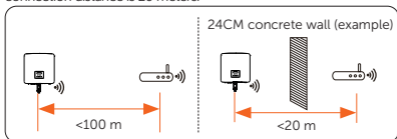

*Note:

When the Wi-Fi signal is weak, please install a Wi-Fi signal booster at the appropriate location.

- LAN Mode

1 Disassemble the waterproof connector into components 1, 2, 3 and 4 ; Component 1 is not used for LAN Mode. Keep it in a safe place.

2 Mount the component 4 to the dongle back cover;

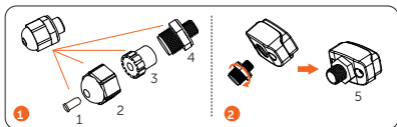

3 Thread the network cable through the following components (2-3-5);

4 The male RJ45 of network cable connects to the female RJ45 on the dongle. Then connect them to the home router.; (a "Click" will be heard if it is successfully connected) Another side of the network cable connects to home router. Make sure the home router is in good condition;

5 Clockwise tighten the components (5-3-2) of Pocket WiFi+LAN in sequence;

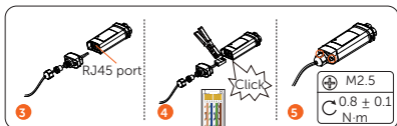

* Note: Refer to "Wi-Fi Mode" for connection steps on the inverter.

Monitoring Connection / Überwachungs-Anschluss
/ Branchement de surveillance / Conexión de
monitorización / Ligação à Monitorização / Monitoring-
aansluiting / Collegamento monitoraggio / Połączenie
na potrzeby monitorowania / Připojení ke sledování /
Övervakningsanslutning / Conexiune de monitorizare
/ Мониторингова връзка / Overvågningsforbindelse /
Σύνδεση παρακολούθησης / Seire ühendus /Valvontaliitäntä
/ Priključak za nadzor / Monitoring bekötés / Stebėjimo
ryšys /Uzraudzības savienojums / Pripojenie monitorovania
/ Povezava za spremljanje

• SolaXCloud App Registration

Step 1: Scan the QR code to download SolaXCloud App



Step 2: Select the language

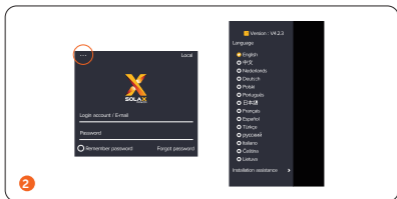

Step 3: Create a new account and follow the tutorial on the SolaXCloud APP or the App guide at <https://www.solaxcloud.com/> to complete the Wi-Fi configuration.

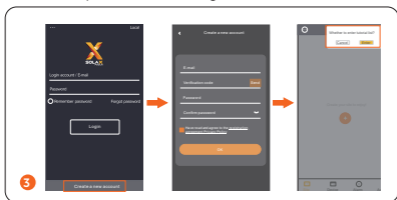

Step 4: Scan the QR code for more details of local mode login and the troubleshooting of Wi-Fi connection.



- Monitoring Website Registration

* Note: Make sure the computer or laptop is well connected with the network.

Step 1: Open the browser, type www.solaxcloud.com/ into the browser;

Step 2: Select the language and complete the registration, login, site adding and other related operations following the "User Guide"- "Web guide".

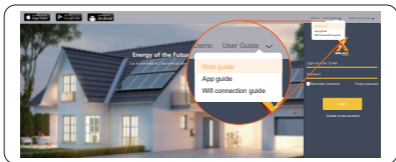

Appearance and Dimensions / Aussehen und Abmessungen / Apparence et dimensions / Aspecto y dimensiones / Aspeto e Dimensões / Uiterlijk en afmetingen / Aspetto e dimensioni / Wygląd i wymiary / Vzhled a rozměry / Utseende och mått / Aspect și dimensiuni / Външен вид и размери / Udseende og dimensioner / Εμφάνιση και διαστάσεις / Välimus ja mõõtmed / Ulkonäkö ja mitat / Izgled i dimenzije / Megjelenés és méretek / Išvaizda ir matmenys / Izskats un izmēri / Vzhľad a rozmery / Videz in dimenzije

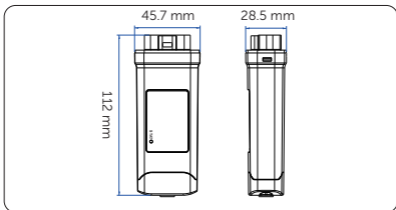

Technical Data / Technische Daten / Fiche technique /
 Datos técnicos / Dados Técnicos / Technische gegevens /
 Dati tecnici / Dane techniczne / Technické údaje / Tekniska
 data / Date tehnice / Технически данни / Tekniske data /
 Τεχνικά δεδομένα / Tehnilised andmed / Tekniset tiedot /
 Tehnički podaci / Műszaki adatok / Techniniai duomenys /
 Tehniskie dati / Technické údaje / Tehnični podatki

Model	Pocket WiFi+LAN
Power Supply	5 V 200 mA DC
Rated Power	1.4 W
Data Transfer Intervals	5 min
EIRP Power	17.41 dBm (Measured Max. Average)
Antenna Gain	3 dBi
Wi-Fi standard	802.11 b/g/n
Wi-Fi Band	2.400~2.472 GHz
LAN Bandwidth	10/100 M
Weight	80±10 g
Degree of Protection	IP65
Operating Temperature Range	-35°C ~ +60°C
Wireless Module	WiFi 2.4 GHz
Ethernet	10/100 M

Definition of Indicators / Definition der Anzeigen /
 Signification des voyants / Definición de indicadores
 / Definição dos Indicadores / Definitie van indicators
 / Definizione degli indicatori / Definicje wskaźników /
 Definine indikátorů / Definition av indikatorer / Definiția
 indicatorilor / Дефиниция на показателите / Definition på
 indikatorer / Ορισμός ενδεικτικών λυχνιών / Märgutulede
 selgitus / Merkkivalojen määritelmät / Značenje pokazatelja
 / A jelzések meghatározása / Indikatoriu aprašymas /
 Indikatoru definicija / Definiția kontroliek / Opredelitev
 kazalnikov

Method	Wi-Fi	LAN
Steady off	Off	
Green light blink quickly (200 ms)	Disconnect to router	
Green light blink slowly (1 s)	Disconnect to inverter	
Green/Red alternately (200 ms)	Disconnect to MQTT server	
Green light steady on	Connected	

Contact Information

UNITED KINGDOM

 Unit 10, Eastboro Fields, Hemdale
Business Park, Nuneaton, CV11
6GL

 +44 (0) 2476 586 998

 info@solaxuk.co.uk

AUSTRALIA

 12-18 Lascelles St, Springvale
VIC 3171

 +61 1300 476 529

 support@solaxpower.com.au

TURKEY

 Esenşehir Mah. Hale Sk. No:6/1
Ümraniye / İSTANBUL

 +90 (216) 622 58 00 (pbx)

 service.eu@solaxpower.com

GERMANY

 Eisenstraße 3, 65428
Rüsselsheim am Main,
Germany

 +49 (0) 6142 4091 664

 service.eu@solaxpower.com

USA

 3780 Kilroy Airport Way, Suite
200, Long Beach, CA, US 90806

 info@solaxpower.com

NETHERLANDS

 Twekkeler-Es 15 7547 ST
Enschede

 +31 (0) 8527 37932

 service.eu@solaxpower.com

 service.bnl@solaxpower.com

POLAND

 WARSAW AL. JANA P. II 27. POST

 +48 662 430 292

 Thomas.W@solaxpower.com

 service.pl@solaxpower.com

SPAIN

 +34 9373 79607

 tecnico@solaxpower.com

ITALY

 +39 348 2786 409

 tecn.it@solaxpower.com

Brazil

 +55 (34) 9667 0319

 info@solaxpower.com

Warranty Registration Form



For Customer (Compulsory)

Name _____ Country _____
Phone Number _____ Email _____
Address _____
State _____ Zip Code _____
Product Serial Number _____ Date of Commissioning _____
Installation Company Name _____
Installer Name _____ Electrician License No. _____

For Installer

Module (If Any)

Module Brand _____ Module Size(W) _____
Number of String _____ Number of Panel Per String _____

Battery (If Any)

Battery Type _____ Brand _____
Number of Battery Attached _____
Date of Delivery _____ Signature _____

Please visit our warranty website: <https://www.solaxcloud.com/#/warranty> or use your mobile phone to scan the QR code to complete the online warranty registration.



For more detailed warranty terms, please visit SolaX official website: www.solaxpower.com to check it.



SolaX Power Network Technology (Zhejiang) Co., Ltd.

Add.: No. 288, Shizhu Road, Tonglu Economic
Development Zone, Tonglu City, Zhejiang Province,
310000 P. R. CHINA

Tel.: +86 (0) 571 5626 0011

E-mail: info@solaxpower.com / service@solaxpower.com

Copyright © SolaX Power Technology (Zhejiang) Co., Ltd. All rights reserved.



320102066801