

— PHOTOVOLTAIC —

GSE IN-ROOF SYSTEM™

In-Roof Integrated PV system for traditional Photovoltaic Panels

Battening plans for
Landscape and Portrait frames



GSE
Intégration

Battening plan – Position of the reference batten

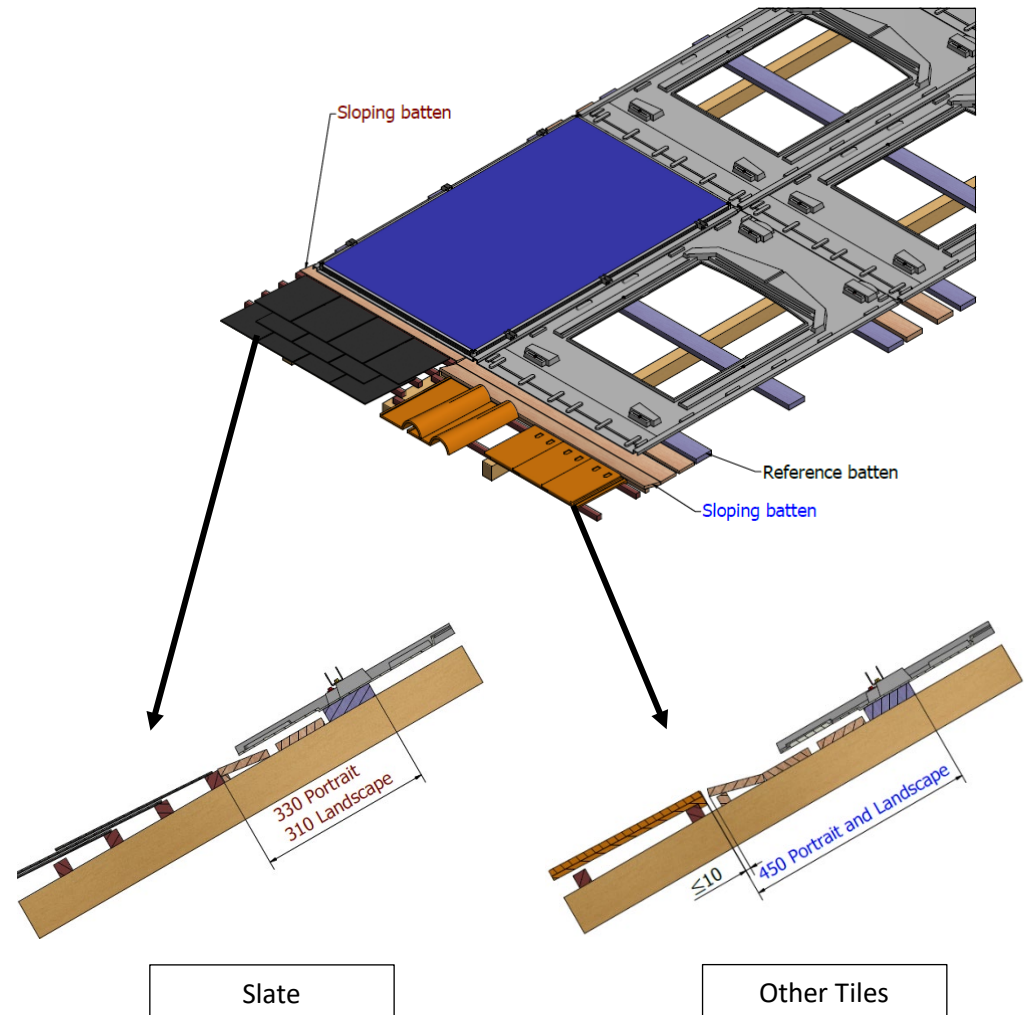
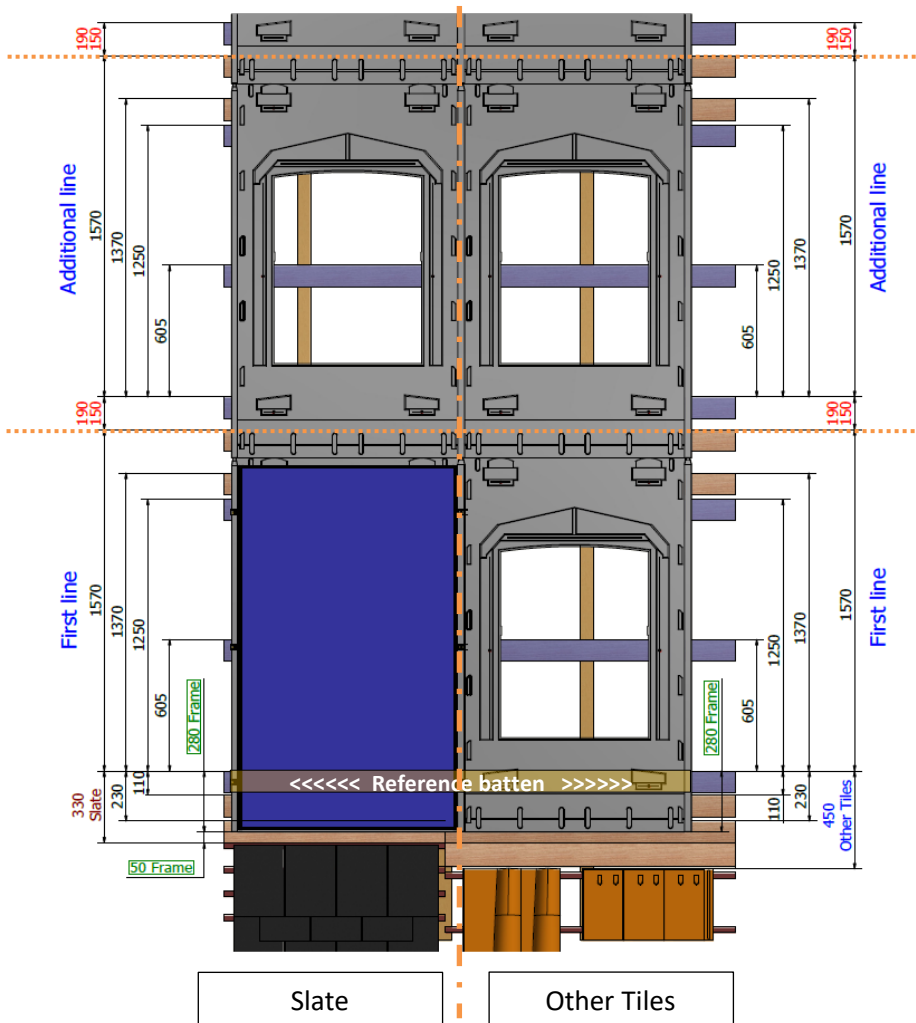

- The reference batten is positioned first, with specific distance from the tiles at the bottom of the photovoltaic field.
- For slates, do not add the batten at the bottom of the field.
- For the other tiles, add the additional sloping batten in order to perform coupling with the curved tiles.
- Position the first frame with the with help of the dimensions highlighted in green.



Battening plans
for Landscape frames

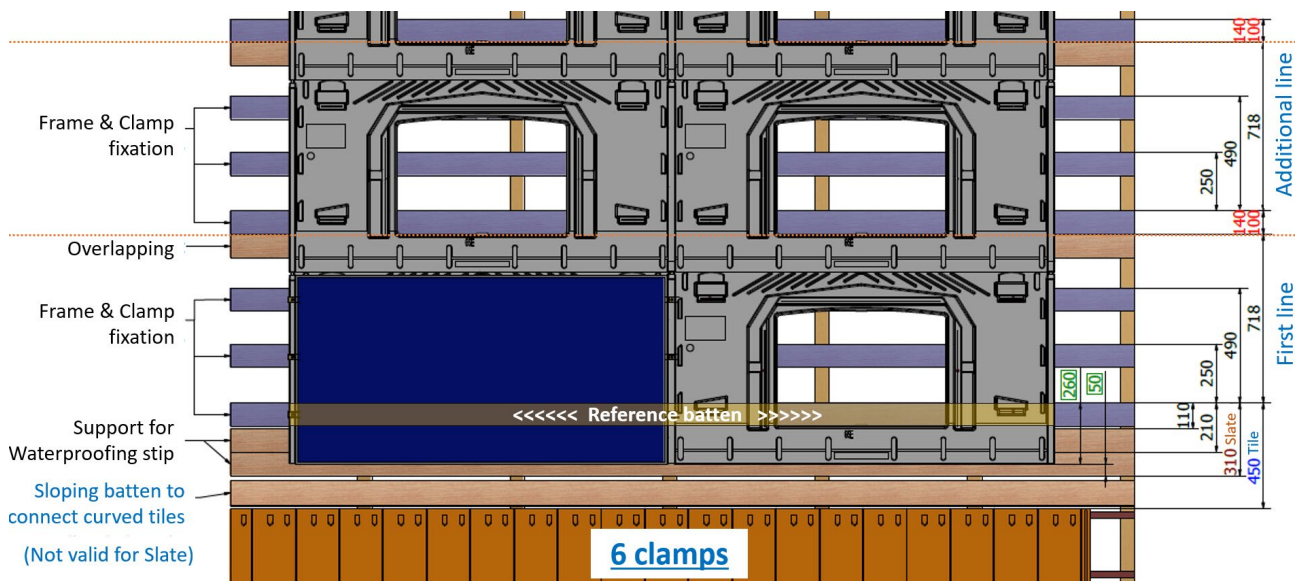
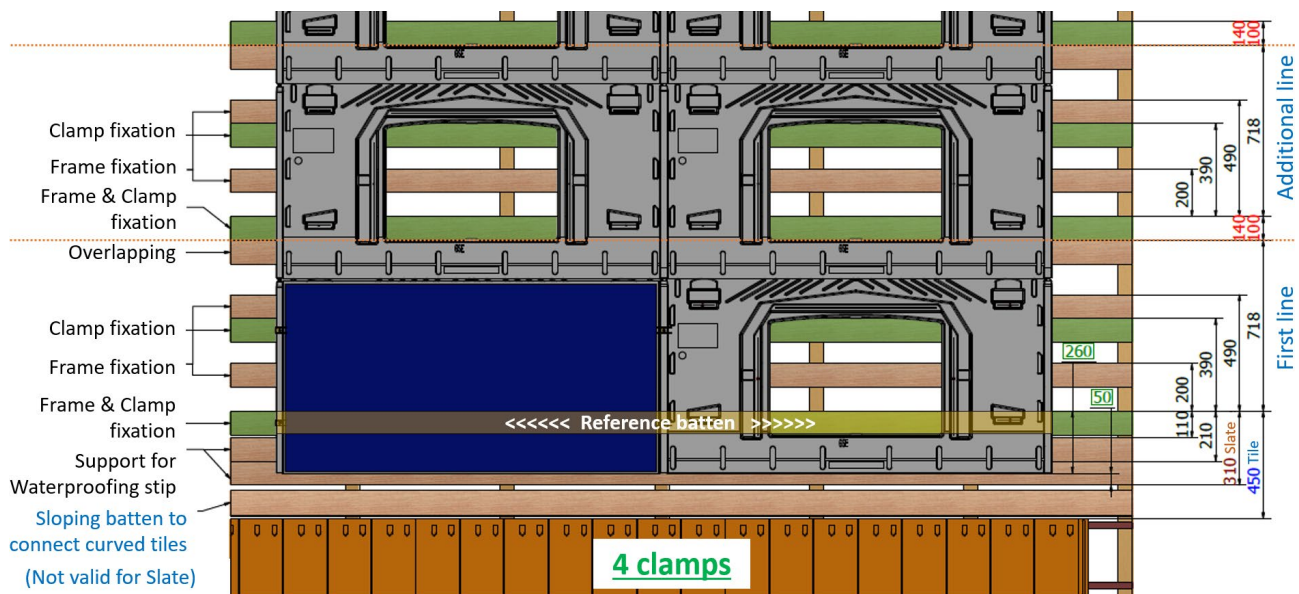

➤ **Batten width¹ = 100mm**

N.B.: the red dimension has to be adjusted according to the panel length: (mm)

Panel length	First line	Additional line
≤808	450 (ou 310) + 718	100 + 718
818	450 (ou 310) + 718	110 + 718
828	450 (ou 310) + 718	120 + 718
838	450 (ou 310) + 718	130 + 718
848	450 (ou 310) + 718	140 + 718

GSE frame reference : 1580/808

¹ The dimension of the batten must comply with the Eurocode specifications according to the wind and snow zones of the Country. Recommendations are given in the installation manual of the GSE In-Roof System. For any questions, please, contact the technical support of GSE Integration.

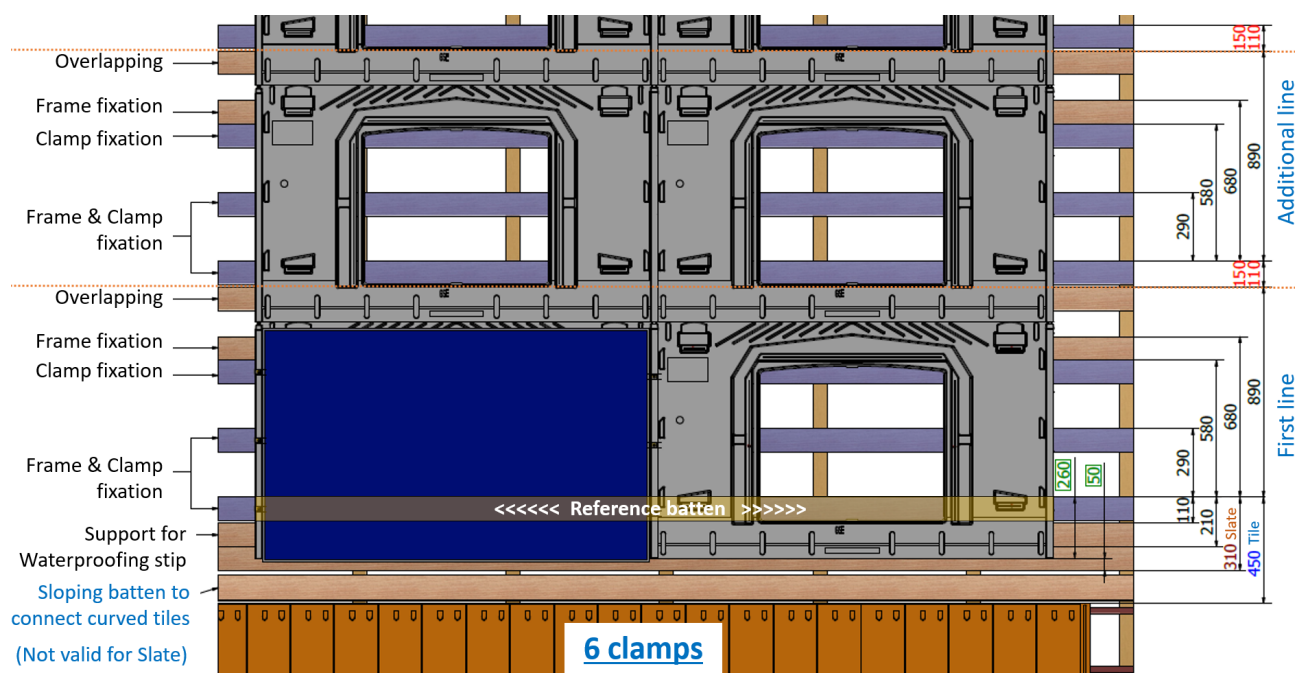
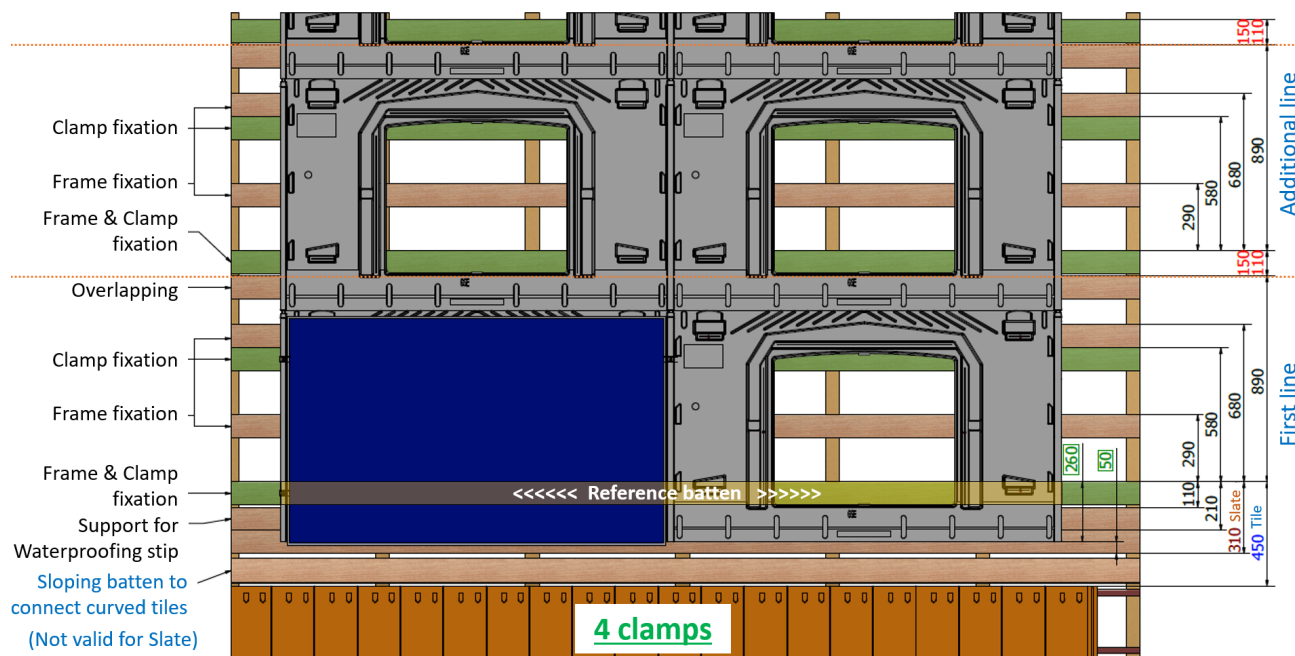

➤ **Batten width**¹ = 100mm

N.B.: the red dimension has to be adjusted according to the panel length: (mm)

Hauteur Panneaux	Premier rang	Rang supplémentaire
≤992	450 (ou 310) + 890	110 + 890
1002	450 (ou 310) + 890	120 + 890
1012	450 (ou 310) + 890	130 + 890
1022	450 (ou 310) + 890	140 + 890
1032	450 (ou 310) + 890	150 + 890

GSE frame references : 1640/992 - 1650/992 - 1660/992 – 1670/992 - 1675/992 - 1680/992 - 1686/1016 - 1700/1016

¹ The dimension of the batten must comply with the Eurocode specifications according to the wind and snow zones of the Country. Recommendations are given in the installation manual of the GSE In-Roof System. For any questions, please, contact the technical support of GSE Integration.

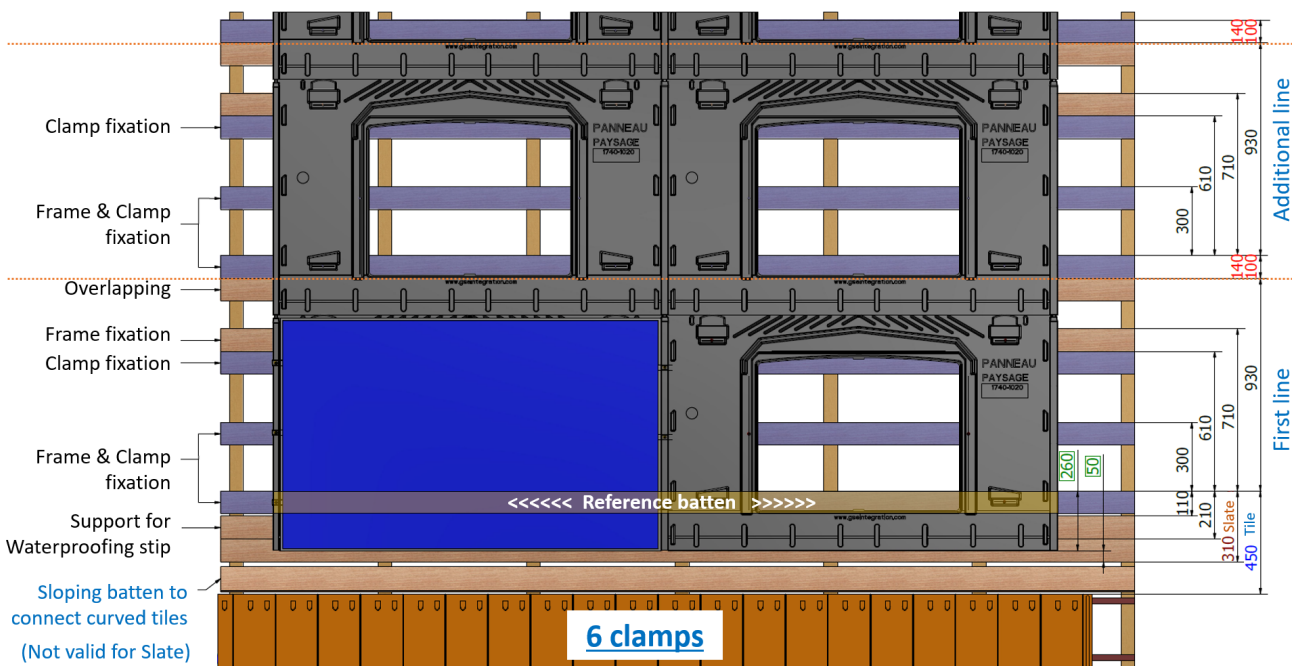
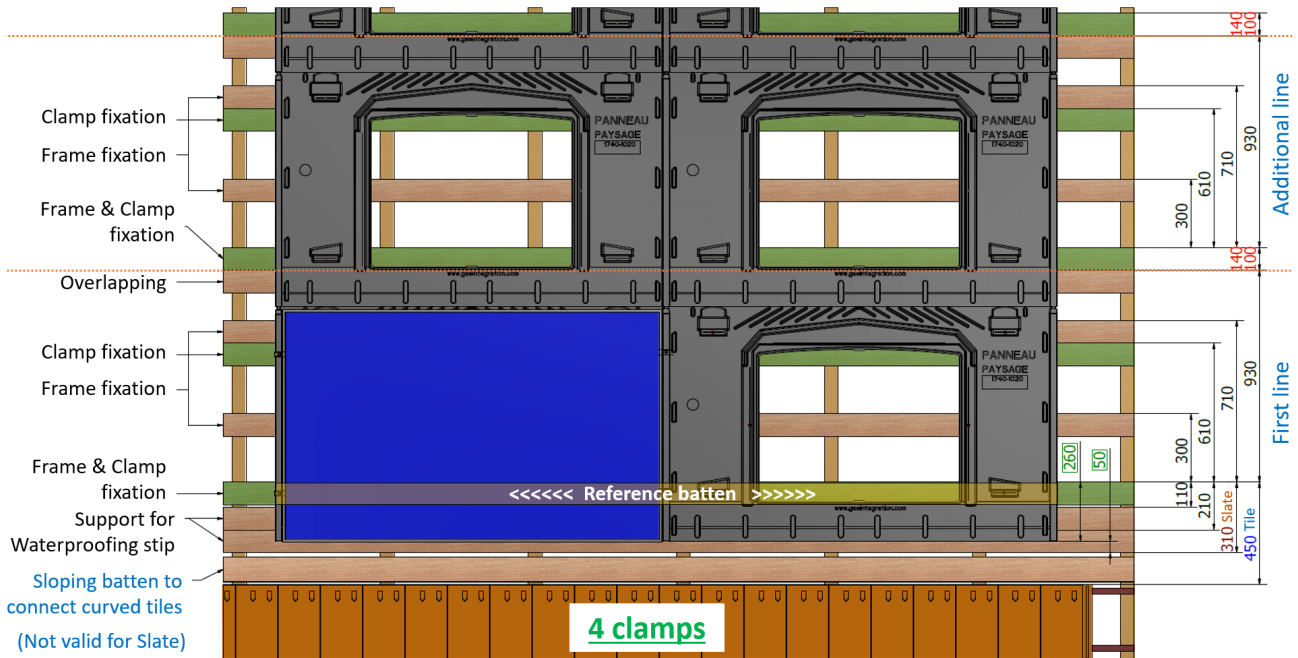

➤ **Batten width**¹ = 100mm

N.B.: the red dimension has to be adjusted according to the panel length: (mm)

Pannel lengthj	First line	Additional line
≤1020	450 (ou 310) + 930	100 + 930
1030	450 (ou 310) + 930	110 + 930
1040	450 (ou 310) + 930	120 + 930
1050	450 (ou 310) + 930	130 + 930
1060	450 (ou 310) + 930	140 + 930

GSE frame references : 1665/1020 - 1675/1020 - 1680/1020 - 1685/1020 - 1690/1020 - 1700/1020 - 1740/1020

¹ The dimension of the batten must comply with the Eurocode specifications according to the wind and snow zones of the Country. Recommendations are given in the installation manual of the GSE In-Roof System. For any questions, please, contact the technical support of GSE Integration.

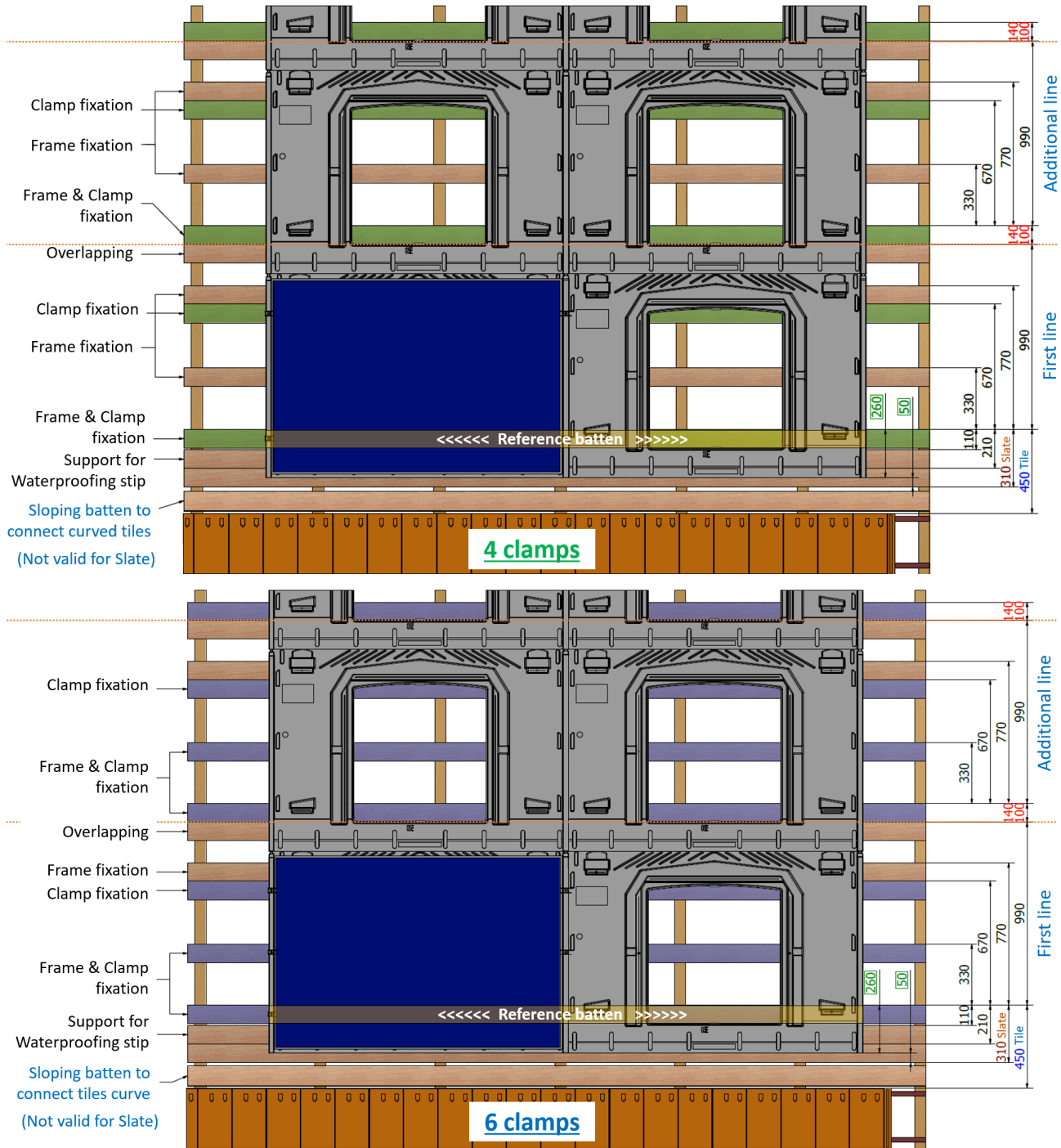

➤ **Batten width**¹ = 100mm

N.B.: the red dimension has to be adjusted according to the panel length: (mm)

Panel length	First line	Additional line
≤1082	450 (ou 310) + 990	100 + 990
1090	450 (ou 310) + 990	110 + 990
1100	450 (ou 310) + 990	120 + 990
1110	450 (ou 310) + 990	130 + 990
1120	450 (ou 310) + 990	140 + 990

GSE frame references : 1559/1046 - 1575/1082

¹ The dimension of the batten must comply with the Eurocode specifications according to the wind and snow zones of the Country. Recommendations are given in the installation manual of the GSE In-Roof System. For any questions, please, contact the technical support of GSE Integration.



Battening plans
for Portrait frames

Battening Plan - Portrait Frame H1575

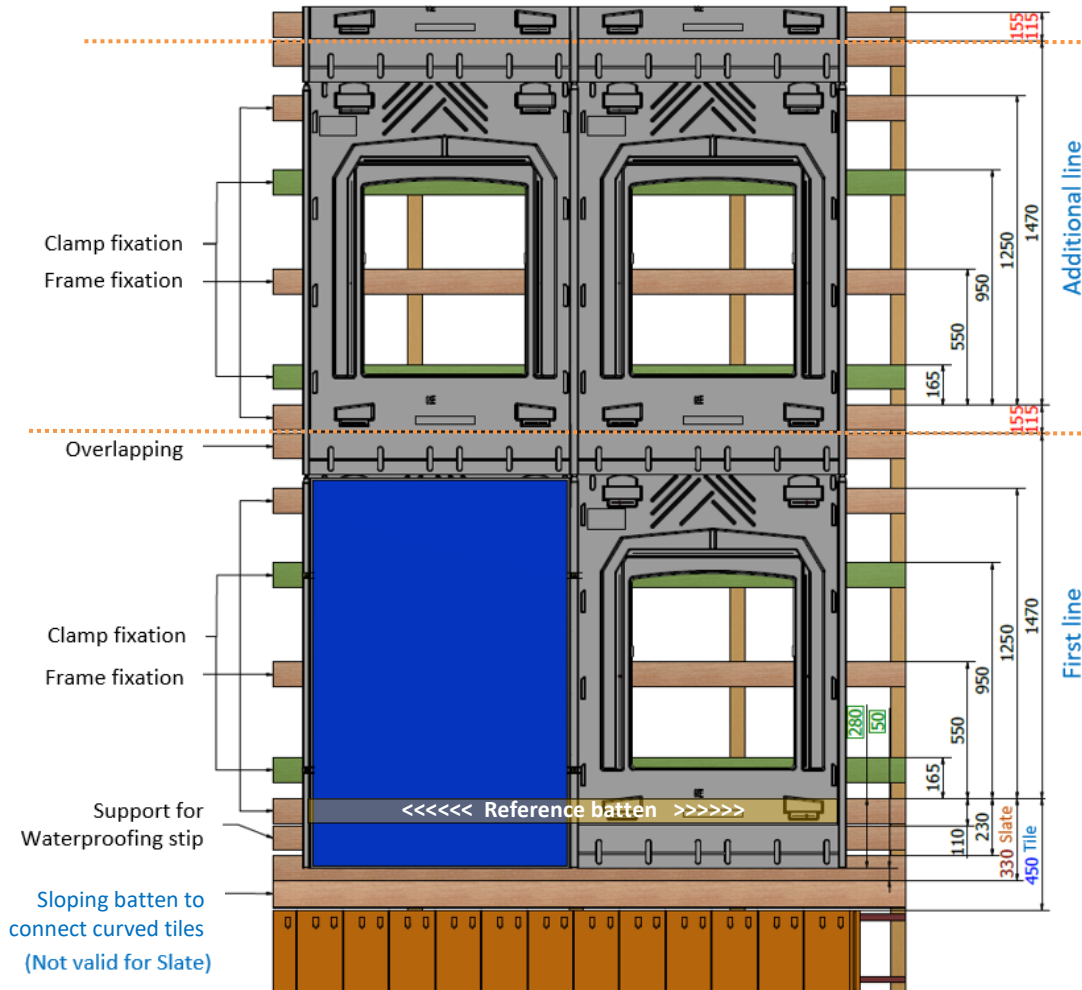

4 Clamps

➤ **Batten width**¹ = 100mm

GSE frame references :

1559/1046 – 1575/1053 – 1575 /1082

¹ The dimension of the batten must comply with the Eurocode specifications according to the wind and snow zones of the Country. Recommendations are given in the installation manual of the GSE In-Roof System. For any questions, please, contact the technical support of GSE Integration.

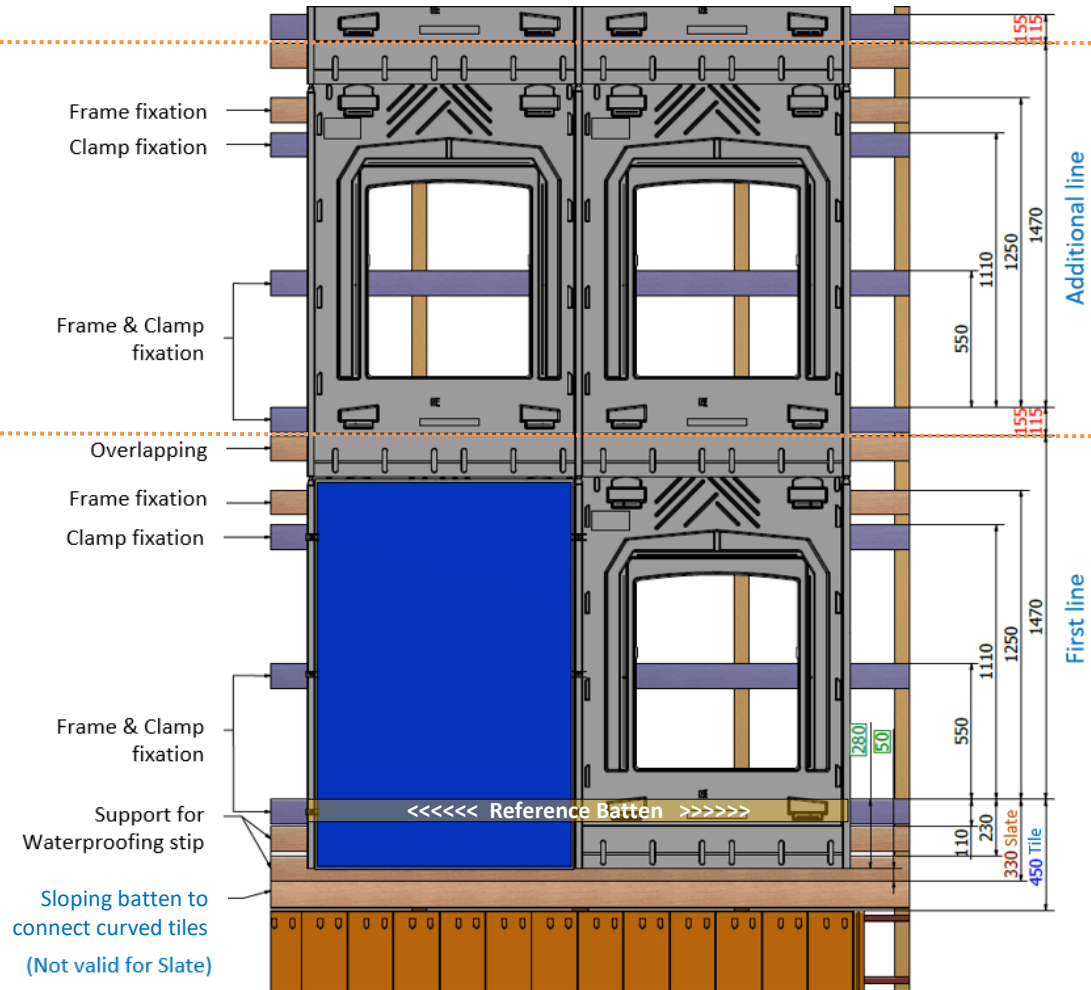

6 Clamps

N.B.: the red dimension has to be adjusted according to the panel length: (mm)

Panel length	First line	Additional line
≤1575	450 (ou 330) + 1470	115 + 1470
1585	450 (ou 330) + 1470	125 + 1470
1595	450 (ou 330) + 1470	135 + 1470
1605	450 (ou 330) + 1470	145 + 1470
1615	450 (ou 330) + 1470	155 + 1470

Battening Plan - Portrait Frame H1580

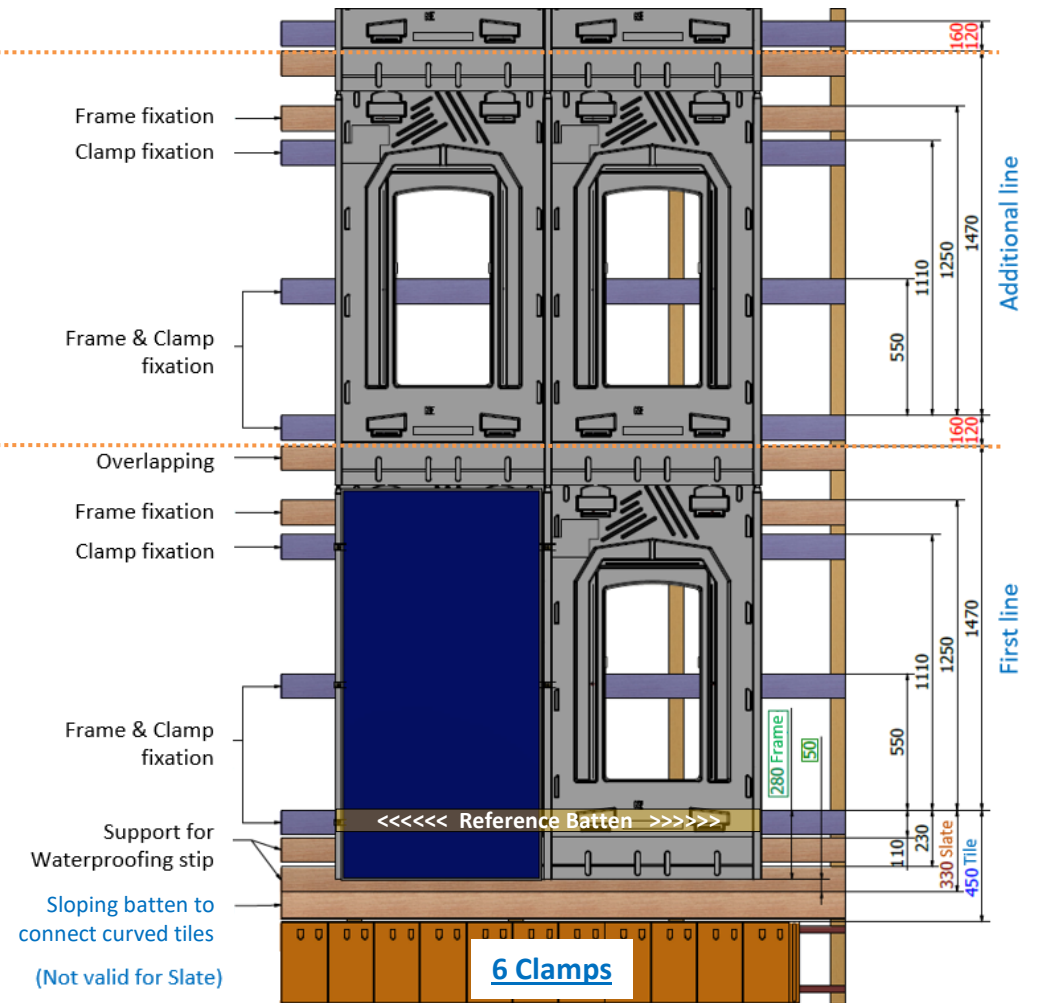
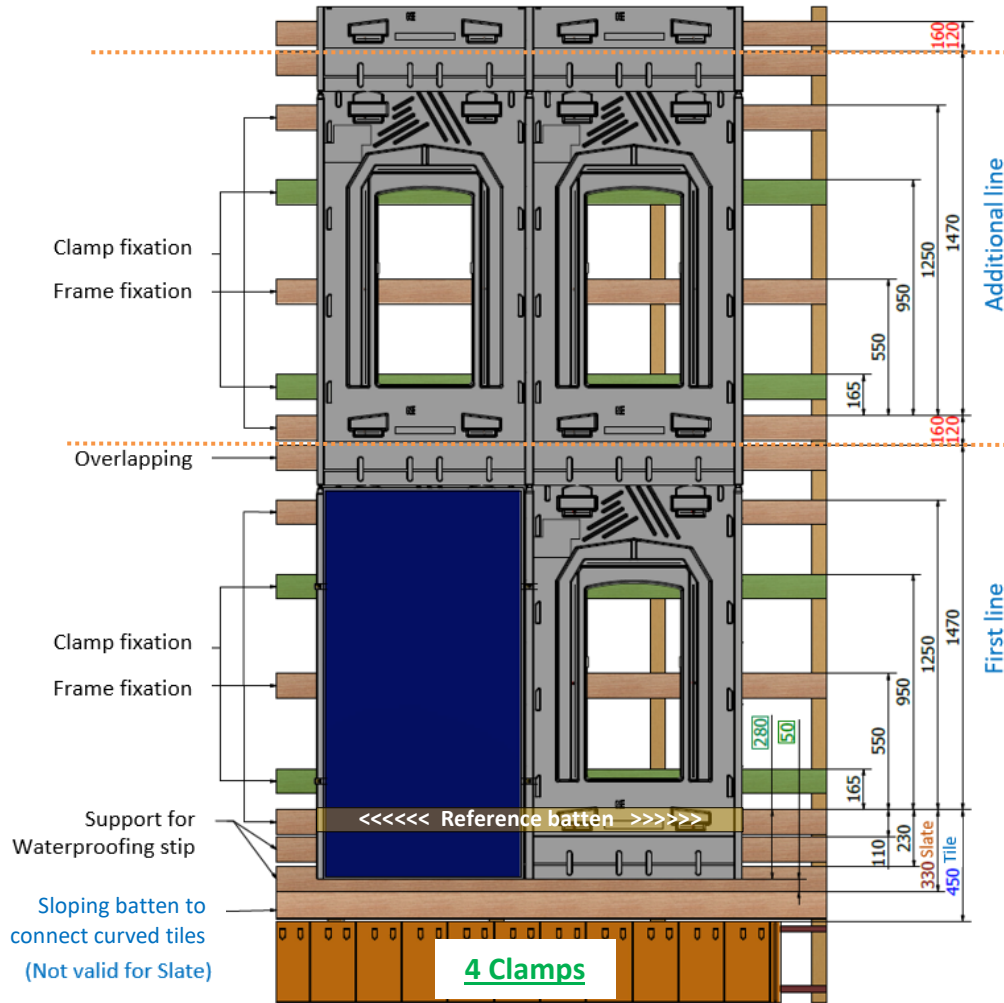

➤ **Batten width**¹ = 100mm

N.B.: the red dimension has to be adjusted according to the panel length: (mm)

GSE frame reference :
1580/808

Panel length	First line	Additional line
≤1580	450 (ou 330) + 1470	120 + 1470
1590	450 (ou 330) + 1470	130 + 1470
1600	450 (ou 330) + 1470	140 + 1470
1610	450 (ou 330) + 1470	150 + 1470
1620	450 (ou 330) + 1470	160 + 1470

¹ The dimension of the batten must comply with the Eurocode specifications according to the wind and snow zones of the Country. Recommendations are given in the installation manual of the GSE In-Roof System. For any questions, please, contact the technical support of GSE Integration.

Battening Plan - Portrait Frame H1640

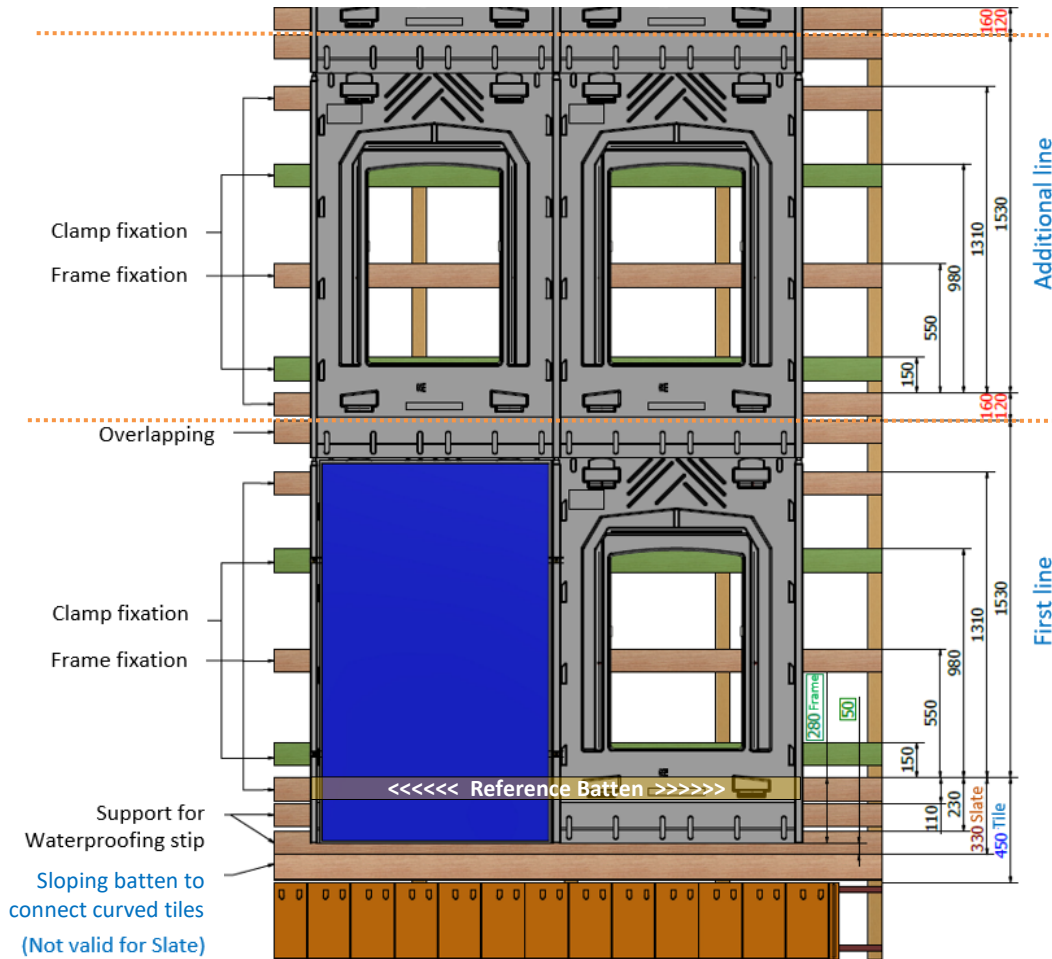

4 Clamps

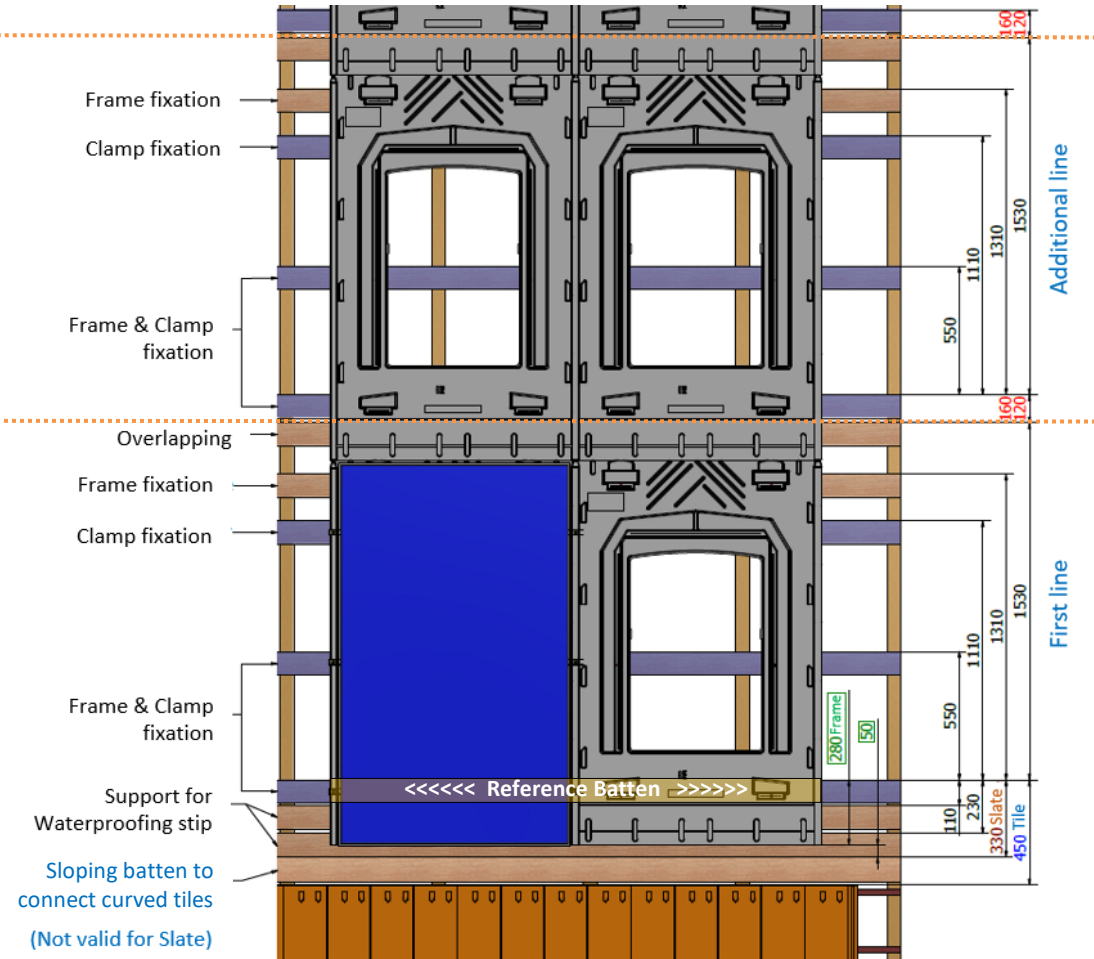

6 Clamps

➤ **Batten width**¹ = 100mm

GSE frame references :
1640/992 – 1640/1001

¹ The dimension of the batten must comply with the Eurocode specifications according to the wind and snow zones of the Country. Recommendations are given in the installation manual of the GSE In-Roof System. For any questions, please, contact the technical support of GSE Integration.

N.B.: the red dimension has to be adjusted according to the panel length: (mm)

Longueur Panneaux	Premier rang	Rang supplémentaire
≤1640	450 (ou 330) + 1530	120 + 1530
1650	450 (ou 330) + 1530	130 + 1530
1660	450 (ou 330) + 1530	140 + 1530
1670	450 (ou 330) + 1530	150 + 1530
1680	450 (ou 330) + 1530	160 + 1530

Battening Plan - Portrait Frame H1686

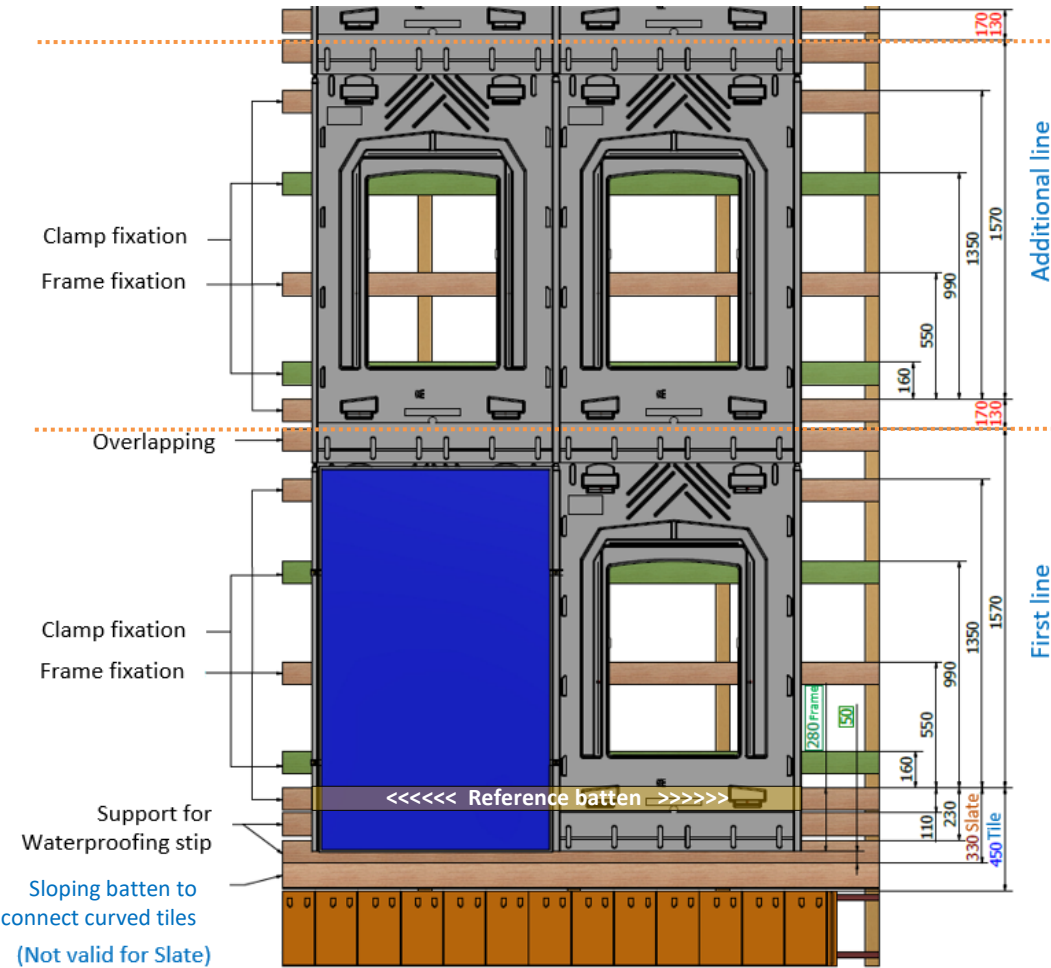

4 Clamps

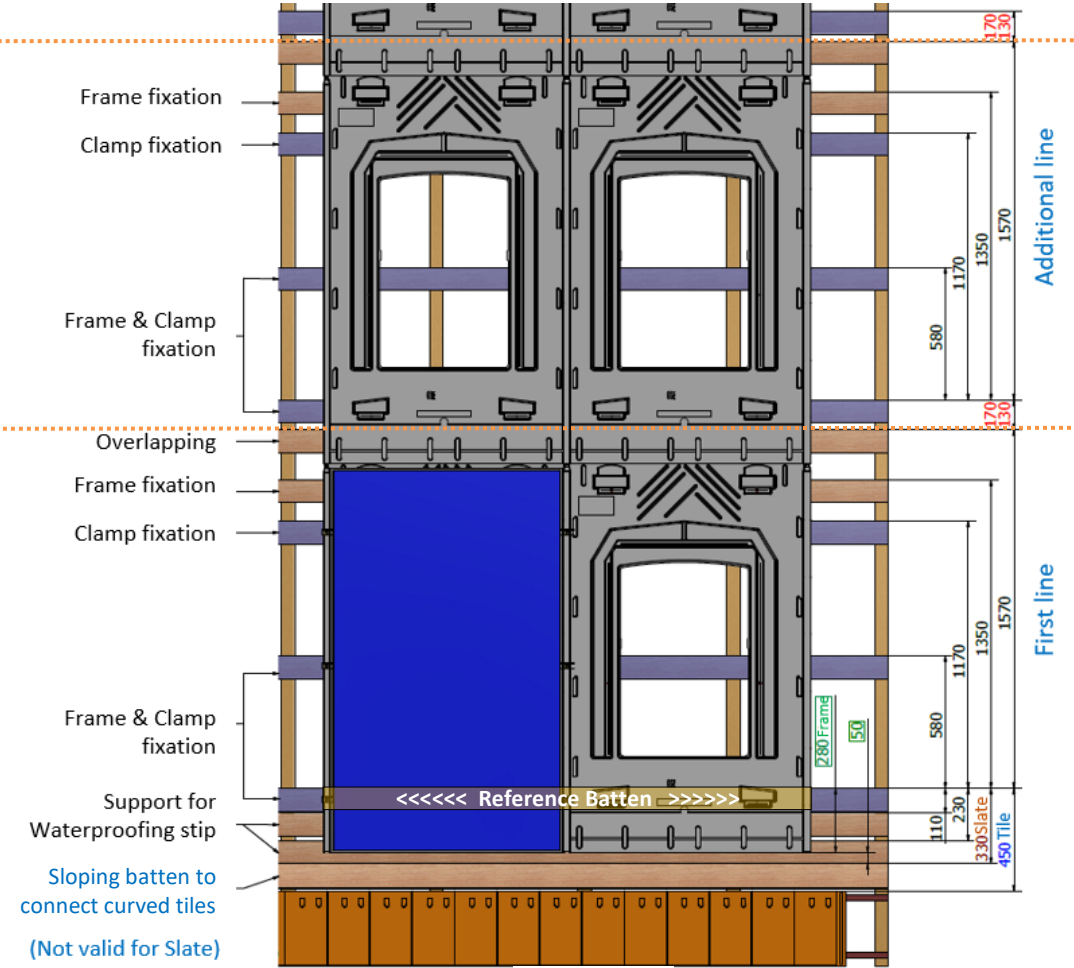

6 Clamps

➤ **Batten width**¹ = 100mm

GSE frame reference :
1686/1016

¹ The dimension of the batten must comply with the Eurocode specifications according to the wind and snow zones of the Country. Recommendations are given in the installation manual of the GSE In-Roof System. For any questions, please, contact the technical support of GSE Integration.

N.B.: the red dimension has to be adjusted according to the panel length: (mm)

Panel length	First line	Additional line
≤1686	450 (ou 330) + 1570	130 + 1570
1696	450 (ou 330) + 1570	140 + 1570
1706	450 (ou 330) + 1570	150 + 1570
1716	450 (ou 330) + 1570	160 + 1570
1726	450 (ou 330) + 1570	170 + 1570

Battening Plan - Portrait Frame H1710

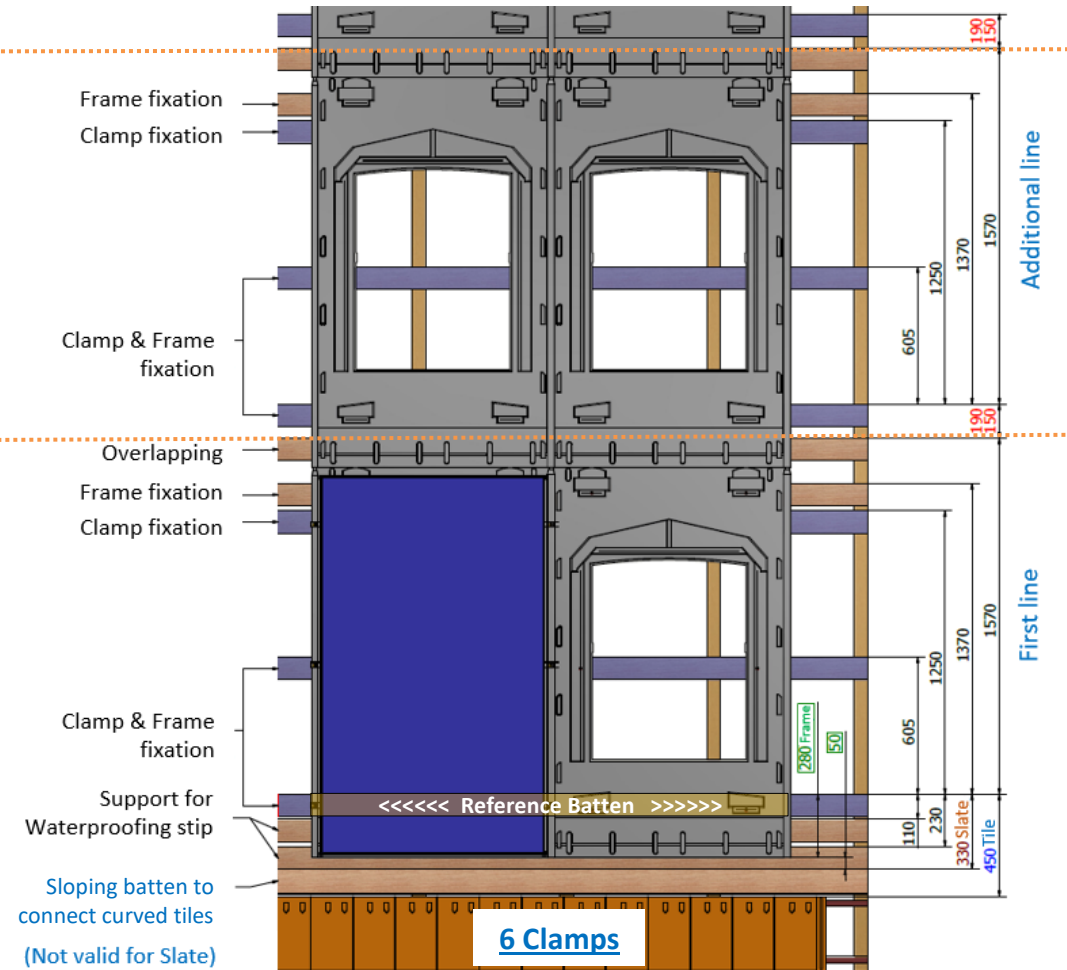
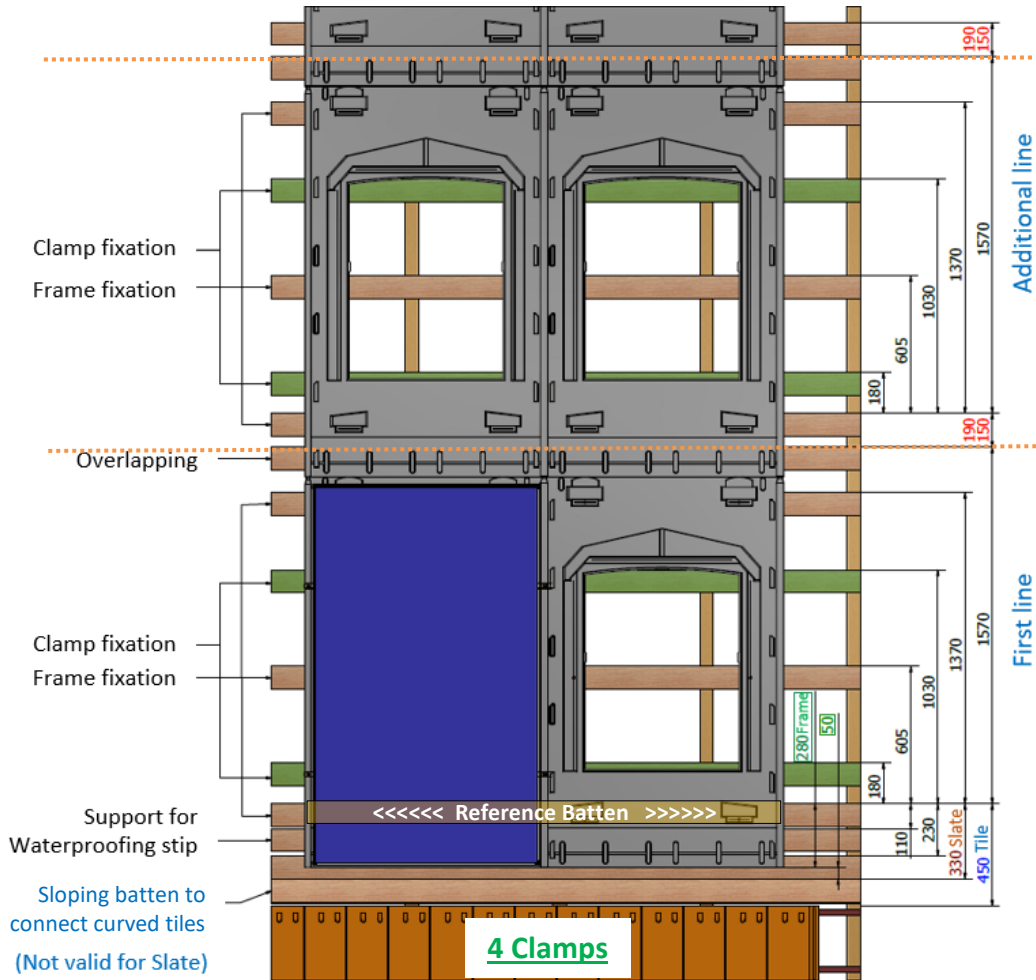

➤ **Batten width**¹ = 100mm

N.B.: the red dimension has to be adjusted according to the panel length: (mm)

GSE frame references :

1710/1000 – 1710/1005 – 1710/1020 – 1710/1025 – 1710/1030 – 1710/1050 – 1710/1060

¹ The dimension of the batten must comply with the Eurocode specifications according to the wind and snow zones of the Country. Recommendations are given in the installation manual of the GSE In-Roof System. For any questions, please, contact the technical support of GSE Integration.

Panel length	First line	Additional line
≤1710	450 (ou 330) + 1570	150 + 1570
1720	450 (ou 330) + 1570	160 + 1570
1730	450 (ou 330) + 1570	170 + 1570
1740	450 (ou 330) + 1570	180 + 1570
1750	450 (ou 330) + 1570	190 + 1570

GSE Intégration

GSE IN-ROOF SYSTEM est un programme de développement breveté
de **GSE INTÉGRATION**

Votre distributeur :